

BT-50

CARPET FLOOR MATS



Be sure to hand Installation Manual over to the customer.

Dual CAB

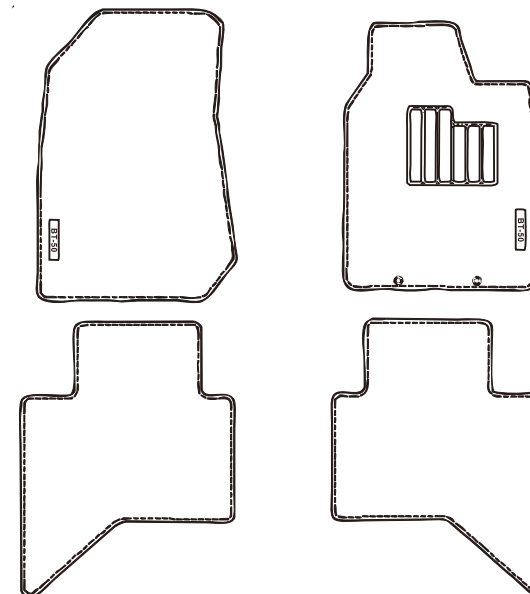

Single/Freestyle Cab

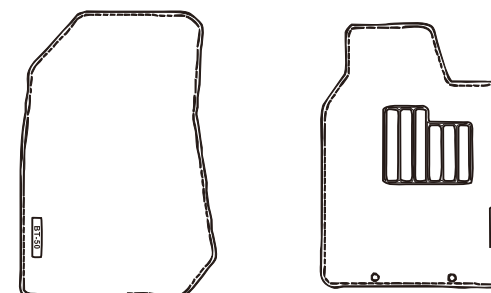

INSTALLATION MANUAL

Applicable vehicle

Bt50 Single/Freestyle CAB (FRONT SET) TF11ACCFMS
BT50 Dual CAB (FRONT & REAR SET) TF11ACCFMD

Tools



Cutter

⚠ WARNINGS

To prevent slippage of ①④ Carpet Floor Mat, be sure to follow the instructions below.

- Properly secure the Carpet Floor Mats using the Clip on the floor.
- Never place the Carpet Floor Mats on top of or underneath another floor mat.
- Failure to follow the above may slide the Carpet Floor Mats forward and disturb driver's ability to use vehicle pedals properly.

⚠ CAUTIONS UPON INSTALLATION

These cautions mentioned hereunder are very important to install this product safely, to prevent damage before it occurs.

- Read this [INSTALLATION MANUAL] thoroughly, before you install the components.
- Preserve this [INSTALLATION MANUAL] at a safe place ready for your reference at needs, after reading.
- Do not install or use this instrument in any other ways except usage in MAZDA vehicle mentioned in front page.
- Check to see if all the parts required are provided before starting installation.
- Be sure to make the vehicle parked at flat place before installing this product.
- Do not use any parts other than those listed in the [INSTALLATION MANUAL]. Otherwise, this product will be damaged.

We cannot hold ourselves responsible for failures and accidents resulting from any misunderstanding of these cautions.

INSTALLATION

Installation of Clips for driver's seat

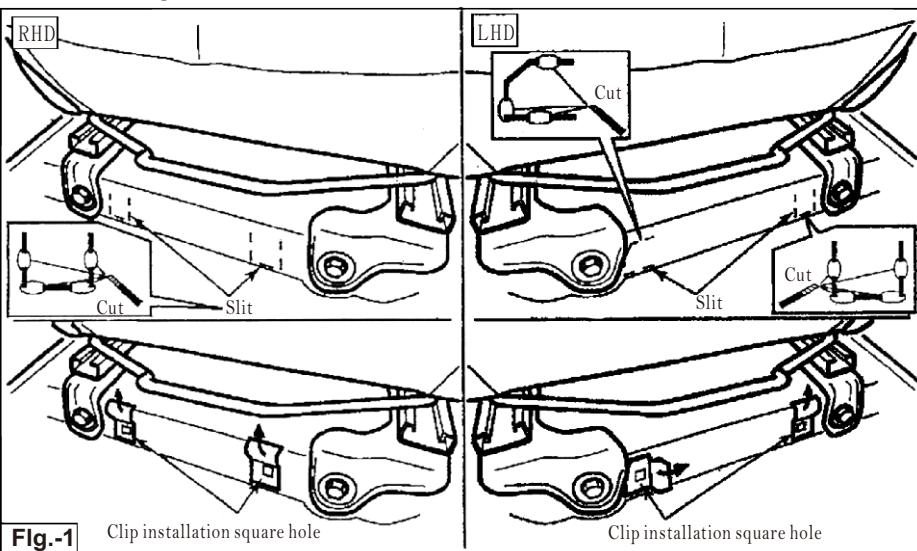

Fig.-1 Clip installation square hole

Clip installation square hole

1. Find slit on the carpet of driver's seat as shown in Fig.1. Next, Cut the slit, and turn up carpet and expose clip installation square holes.

When cutting the slits be careful not to damage the behind floor panel.

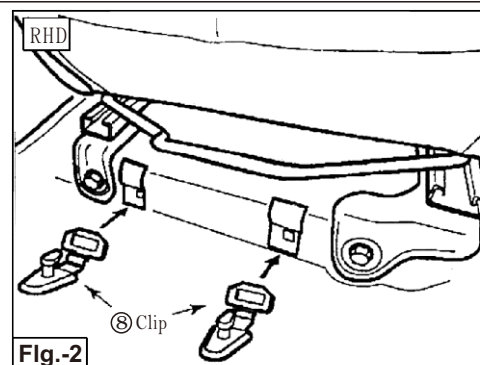

Fig.-2

Installation of Carpet Floor Mat for driver's seat

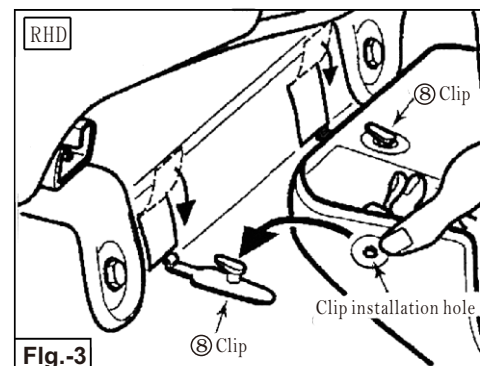

Fig.-3

2. Insert ⑧ clips to the square holes as the direction shown in Fig.2. Be sure two clips are secure locked to the square holes.

As the figure show RHD, handle the installation of LHD in the same manner.

3. Hook ① Carpet Floor Mat (FRT RH) to ⑧ clips by holes provided.

As the figure show RHD, handle the installation of LHD in the same manner.

⚠ CAUTIONS UPON USE

Strongly pull out ①④ Carpet Floor Mat. Will be damaged to ⑧ clips and ①④ Carpet Floor Mat. To remove, please release the holes from ⑧ clips.